

A SECTION - MOUNTABLE CURB AT NOSE OF MEDIAN
40 NOT TO SCALE

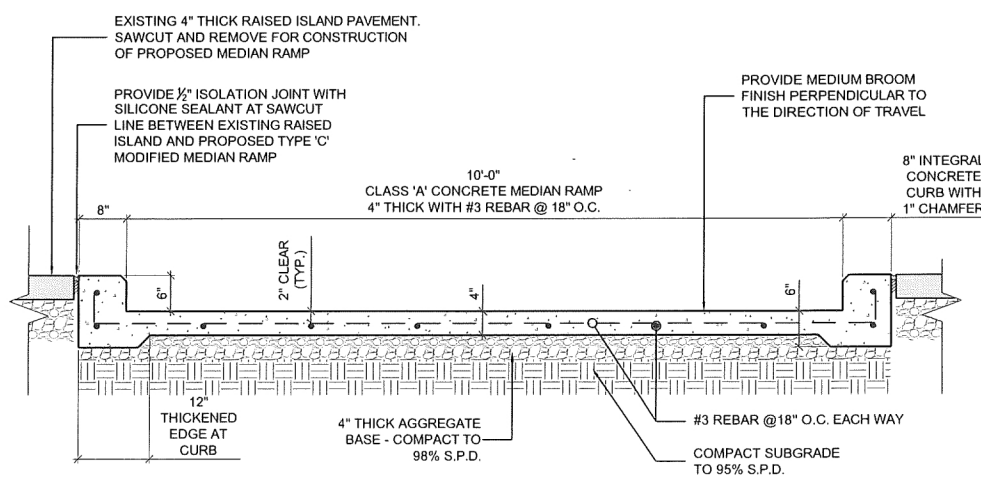
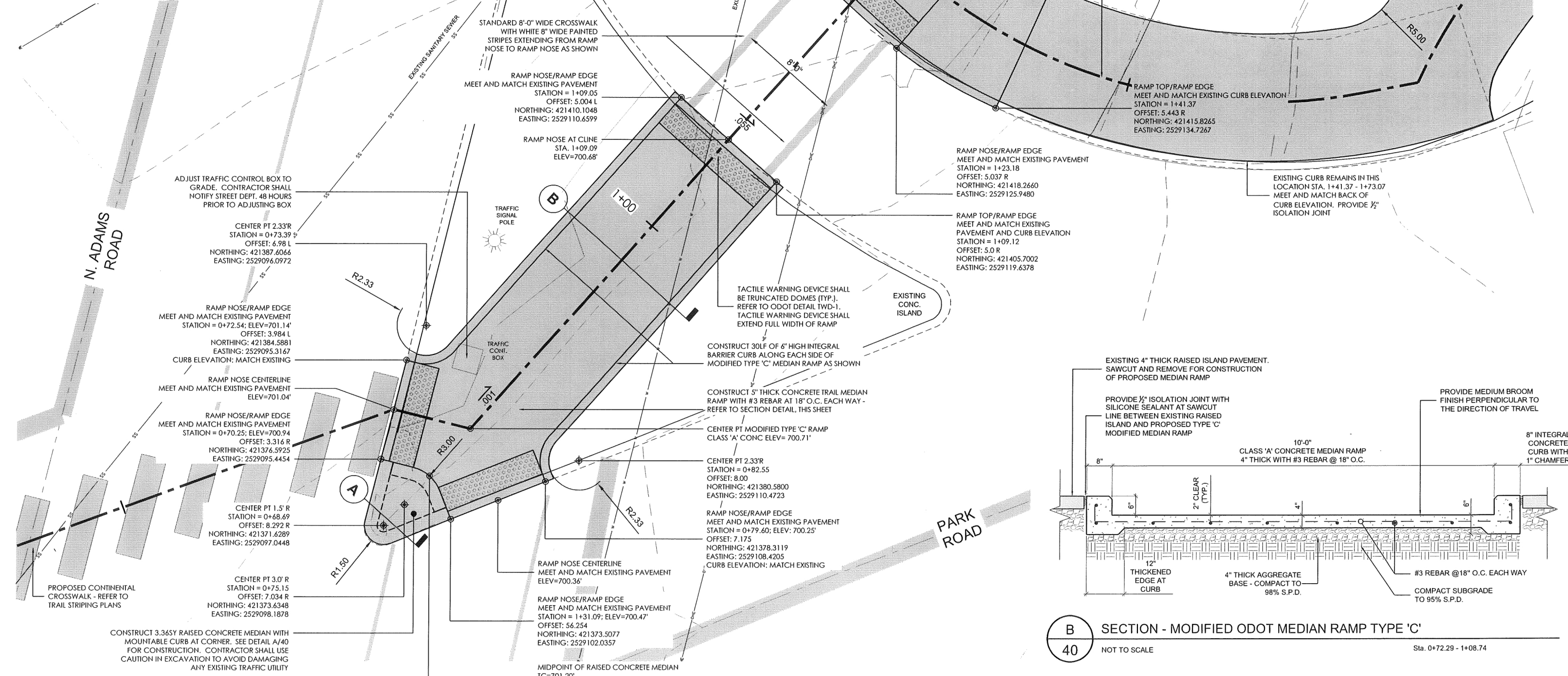

B SECTION - MODIFIED ODOT MEDIAN RAMP TYPE 'C'
40 NOT TO SCALE
Sta. 0+72.29 - 1+08.74

NOTE:
CONTRACTOR SHALL BE RESPONSIBLE FOR COORDINATING WITH THE CITY OF SAND SPRINGS 10 DAYS PRIOR TO THE DEMOLITION AND CONSTRUCTION WITHIN THE MEDIAN SHOWN.

CONTRACTOR SHALL BE RESPONSIBLE FOR THE LOCATION OF BURIED TRAFFIC CONTROL CONDUIT AND CONDUCTOR PRIOR TO BEGINNING CONSTRUCTION. DAMAGE TO EXISTING UTILITIES OR TRAFFIC SIGNAL CONDUIT AND CONDUCTOR OR RELATED ITEMS SHALL BE REPAIRED AT THE CONTRACTOR'S EXPENSE.

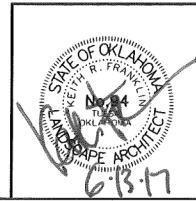
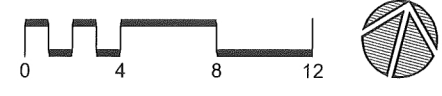

City of Sand Springs - Park Road Trail		PREPARED BY: LANDPLAN CONSULTANTS	
Design	JM 7/16	Tulsa County	
Drawn	JM/BB 8/16	ENLARGEMENT AREA:	
Checked	KF/JM 6/17	PARK ROAD AND N. ADAMS ROAD INTERSECTION	
Approved		STATE JOB NO. 28844(04)	
Squad	LandPlan	Sheet No. 40 of 62	

F:\562 Sand Springs Park Road Trail\Final\Civil 3D - Base Files\ParkRoadTrail-Base1-Final-RI.dwg, 6/8/2017 5:18:31 PM